

**APPENDIX 5:**  
**SKETCH PLANS**

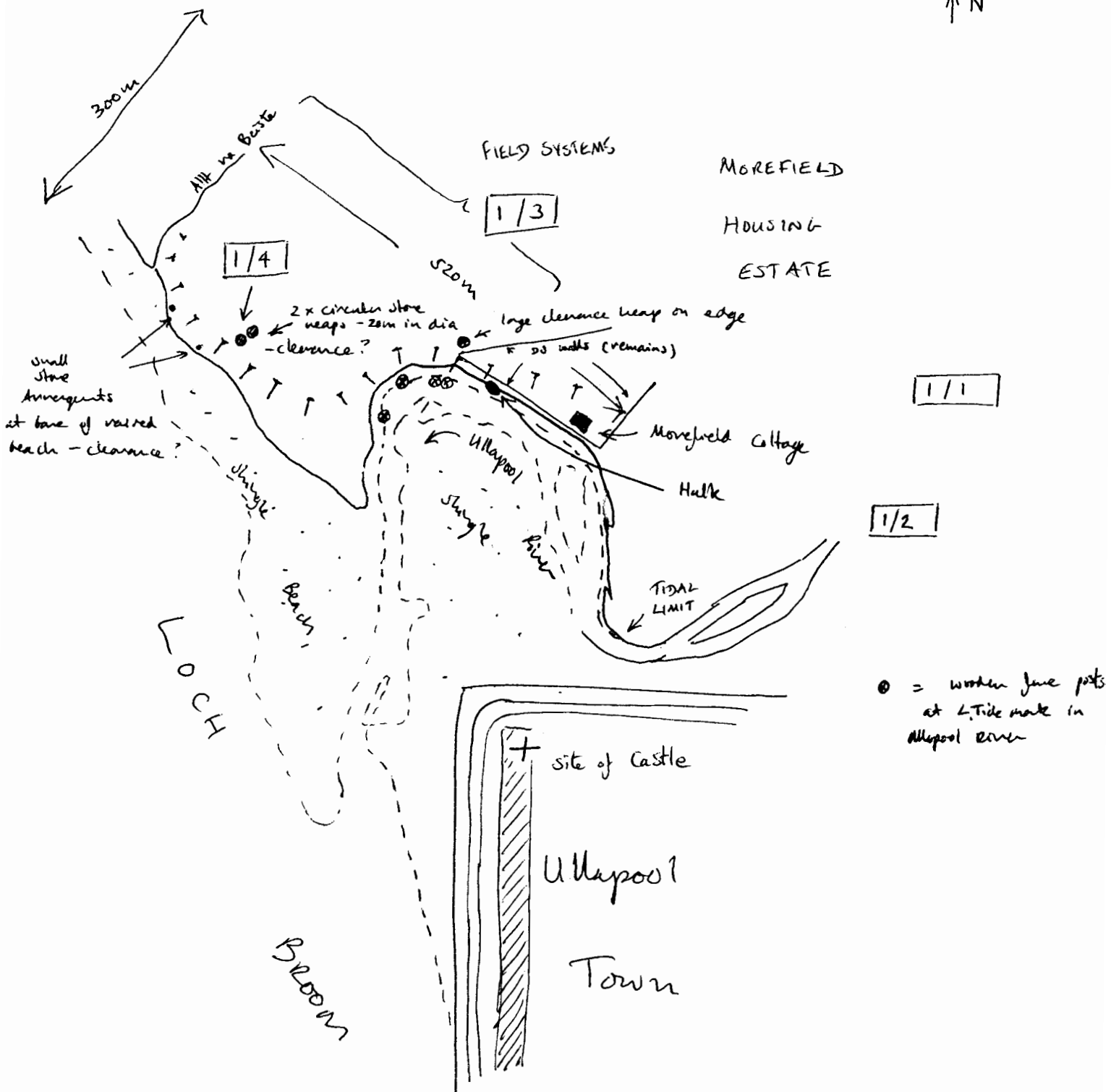

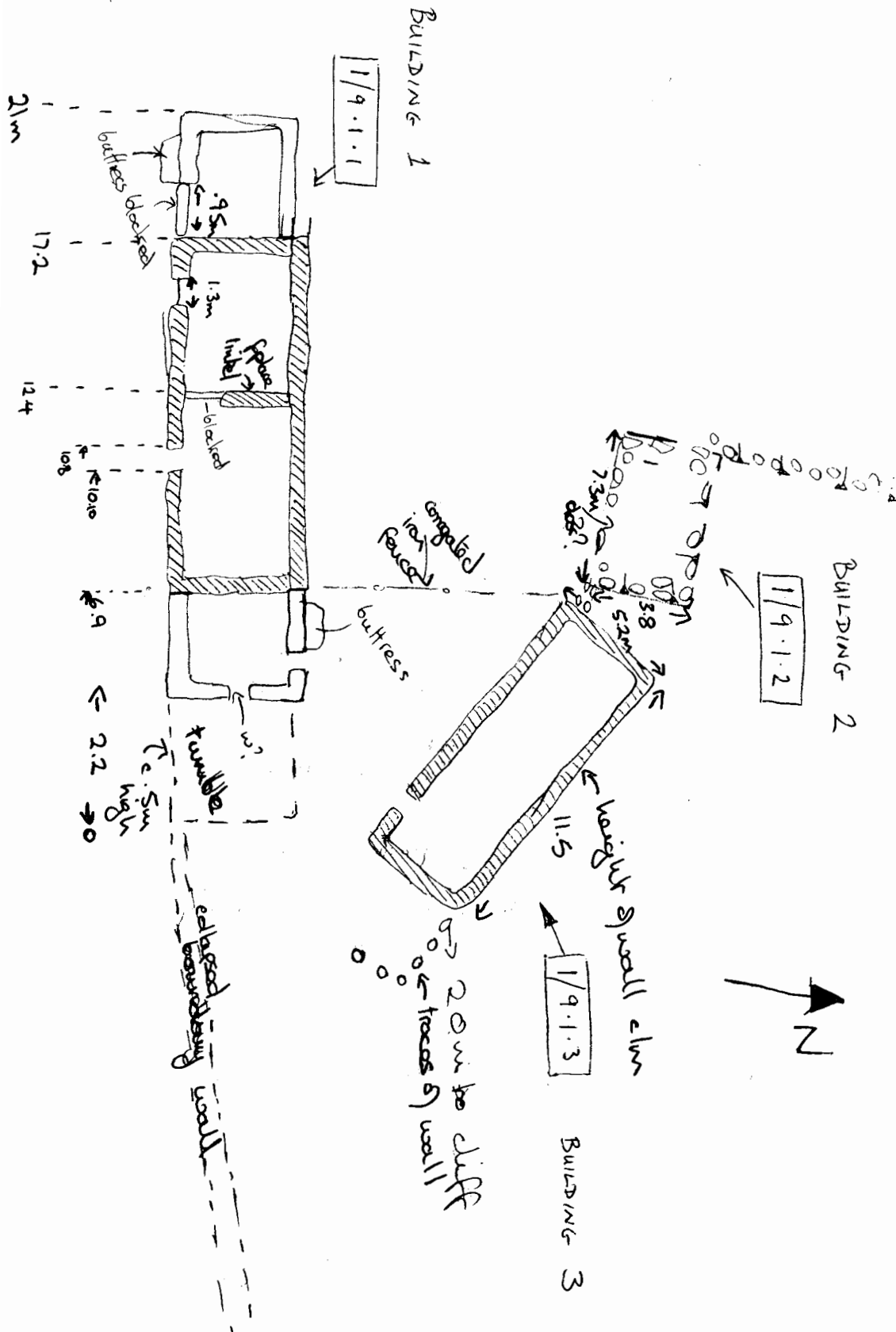

Plan 1: The mouth of the Ullapool River, showing relative locations of sites 1/1 (Morefield Cottage), 1/2 (Ullapool River, hulk), 1/3 (Gob an t-Seid, field systems) and 1/4 (Gob an t-Seid, stone arrangements).



Plan 2: Rhue Township, building complex (1/9.1).

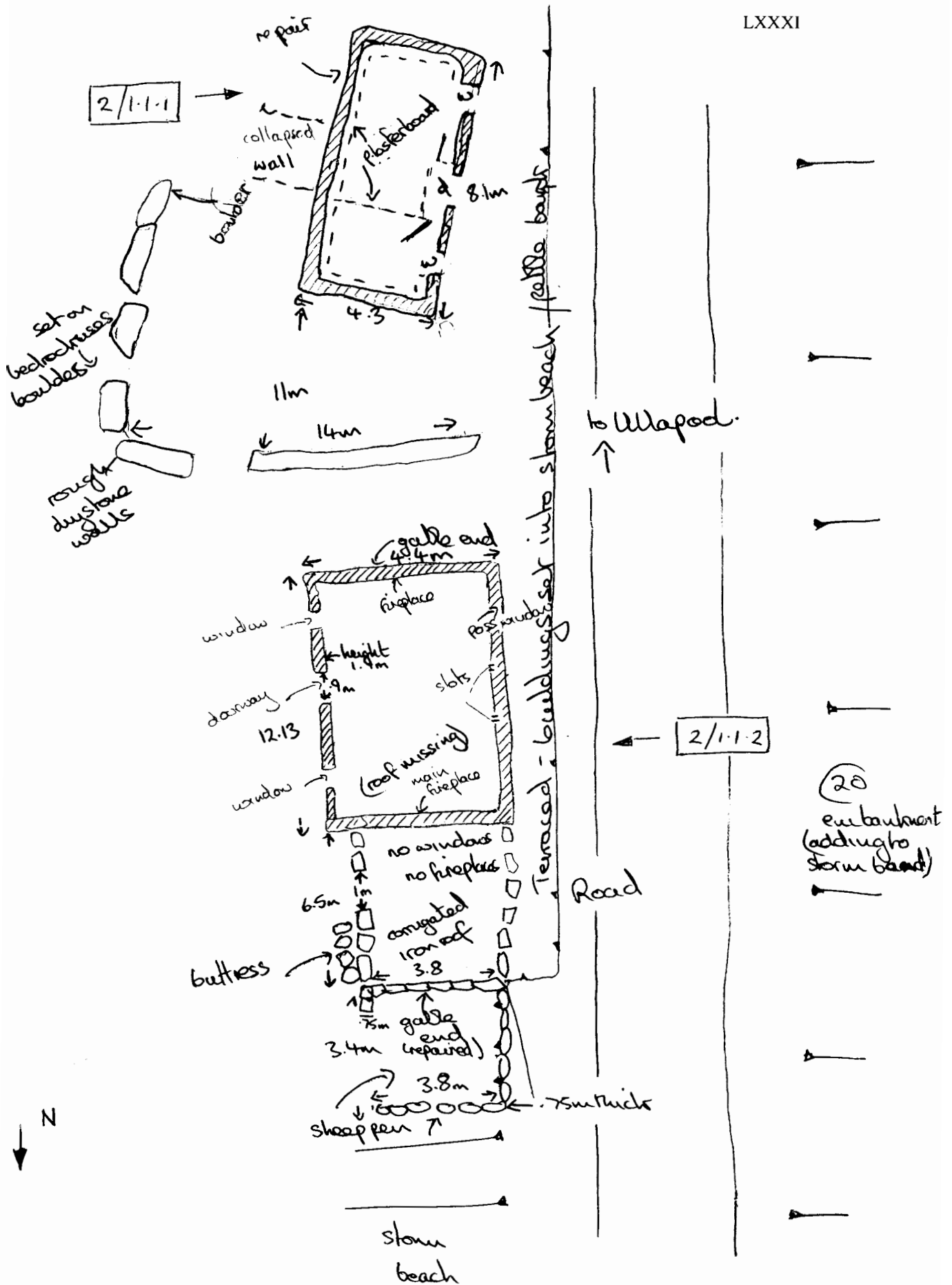

Plan 3: Ardmail Township, building complex (2/1.1).

DUN CANNA

2/13.1

OUTER ENCLOSURE

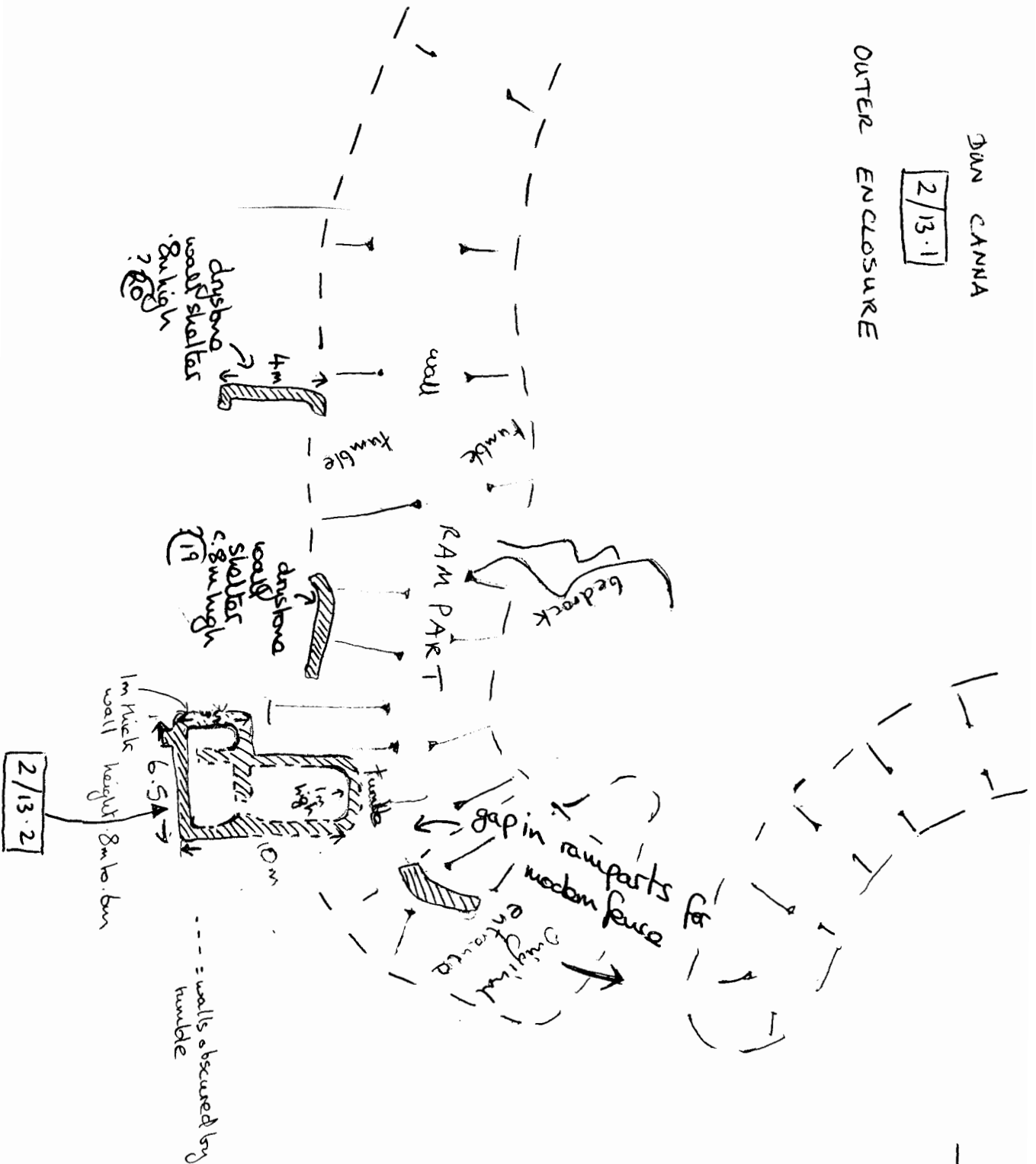

2/13.2

Plan 4: Dun Canna, later building (2/13.2).

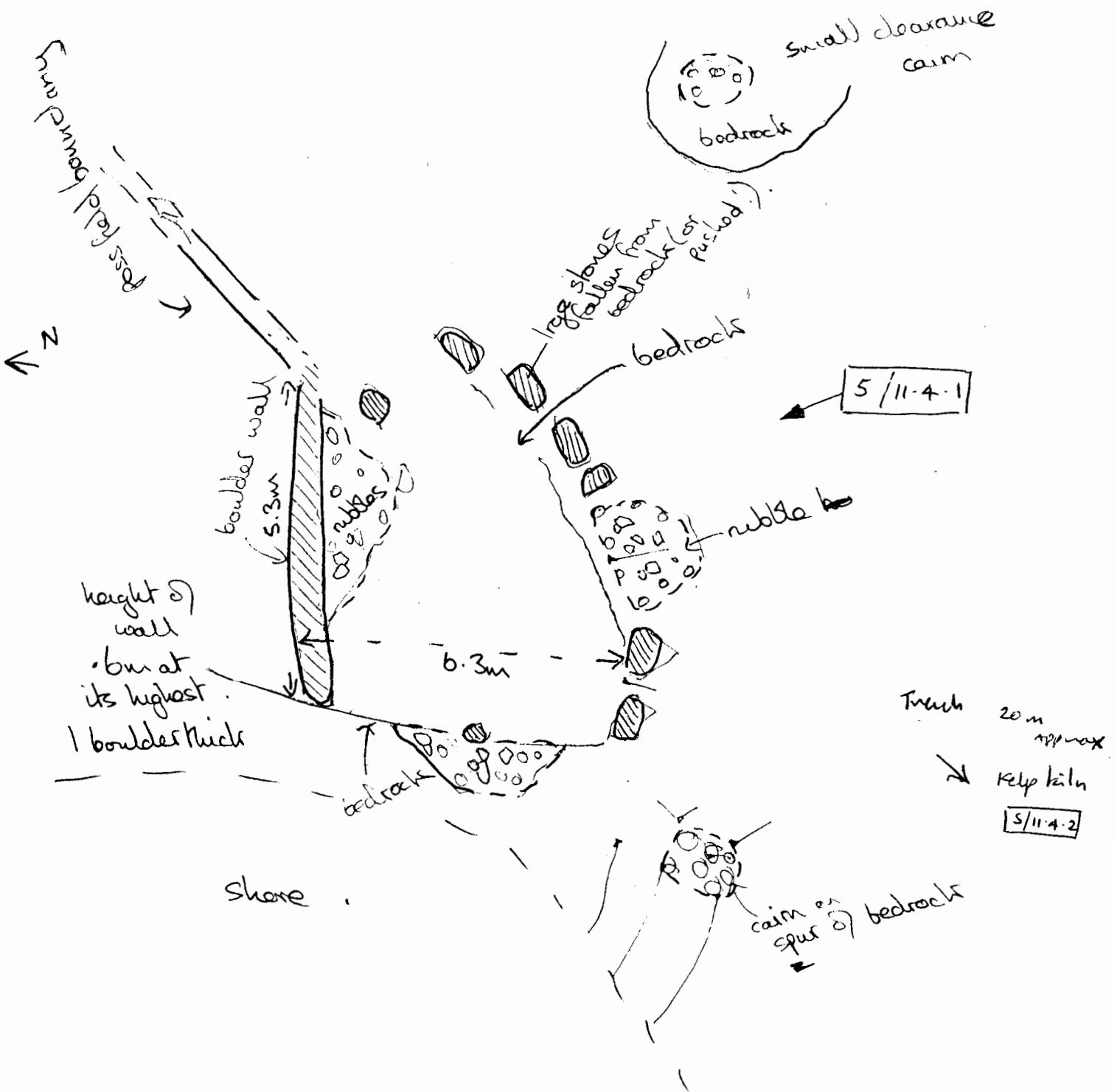

Plan 5: Achiltibuie Township, structure (5/11.4).

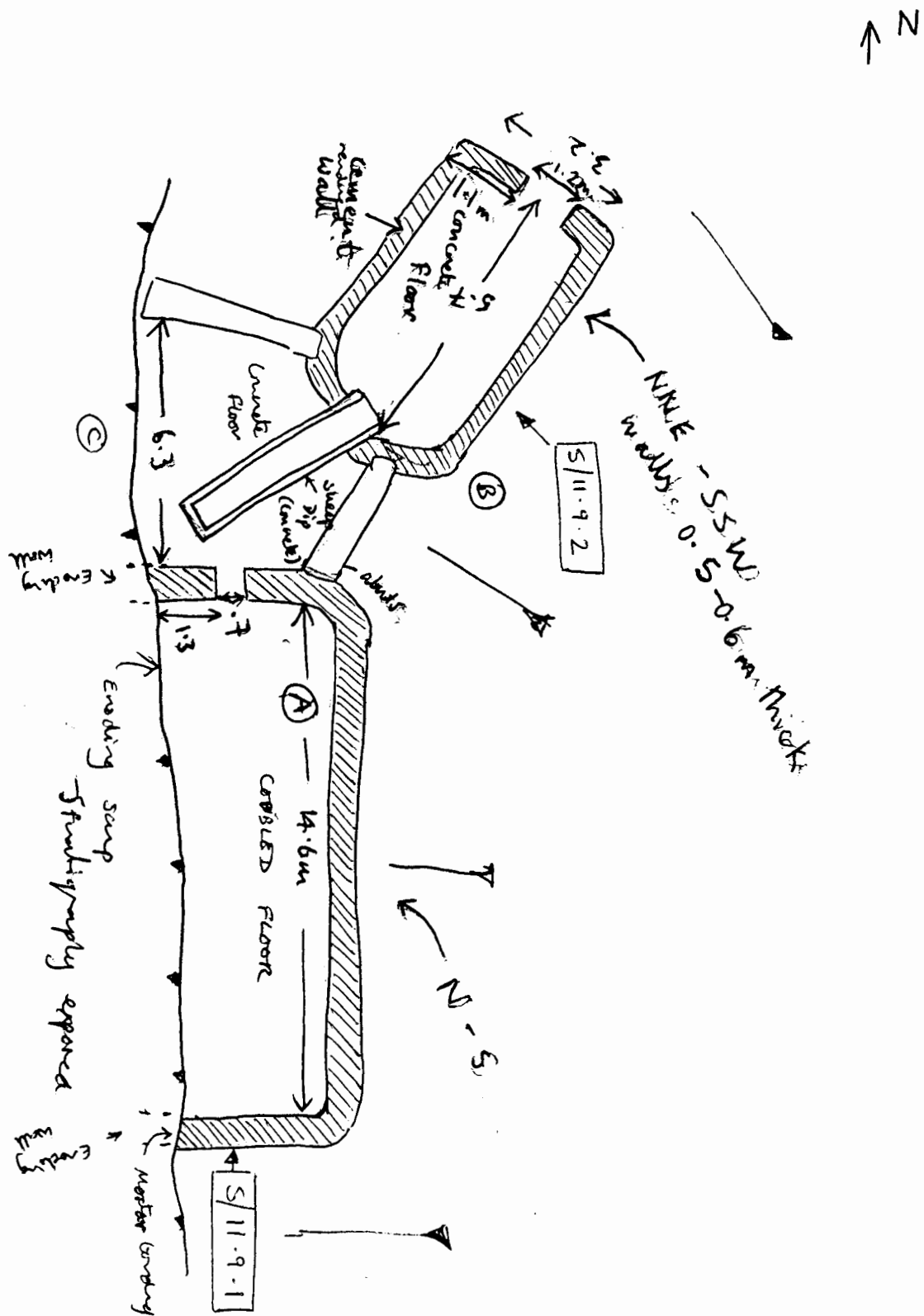

Plan 6: Achiltibuie Township, buildings ? (5/11.9).



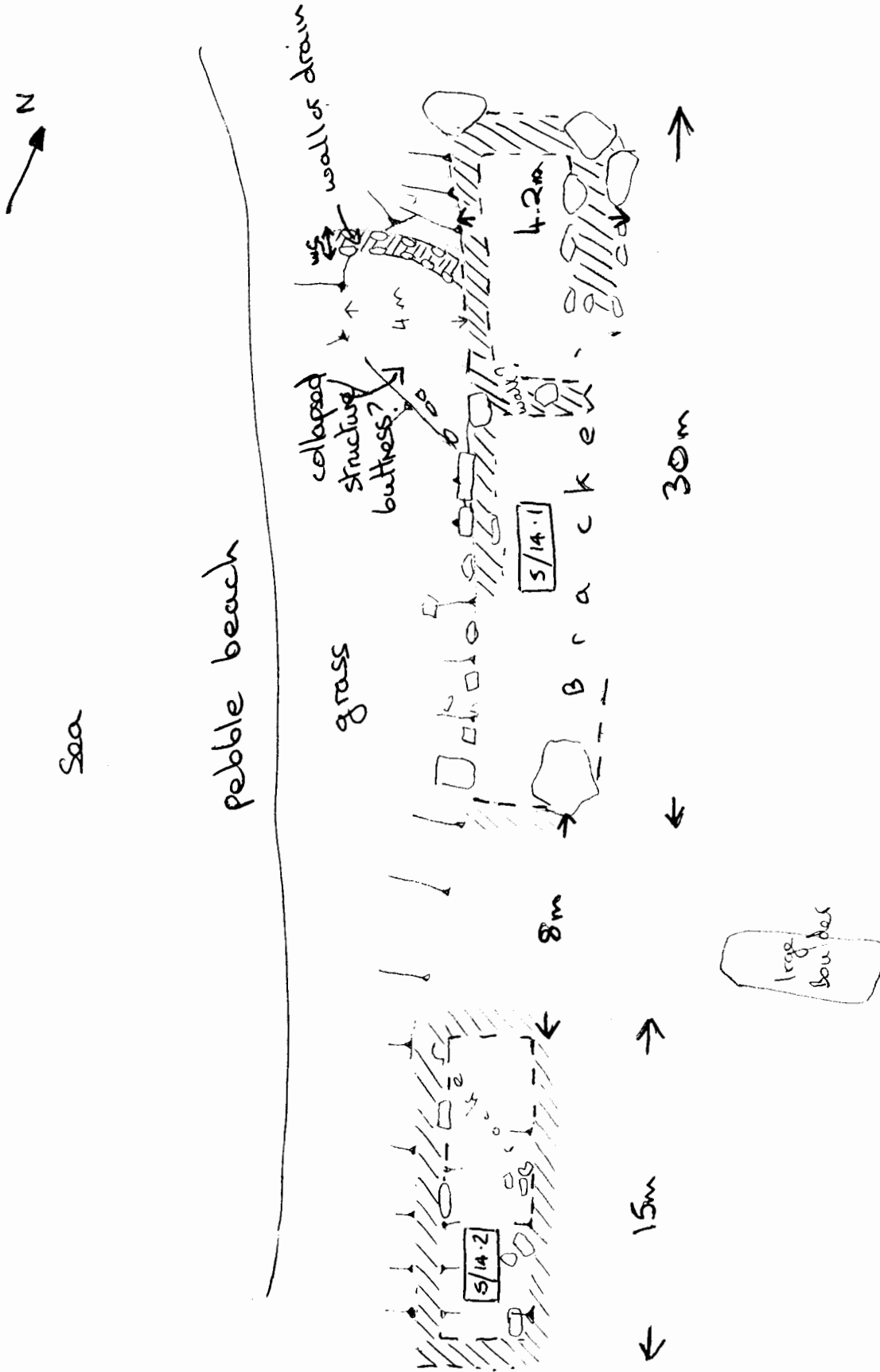

Plan 7: Badentarbat, structures (5/14).

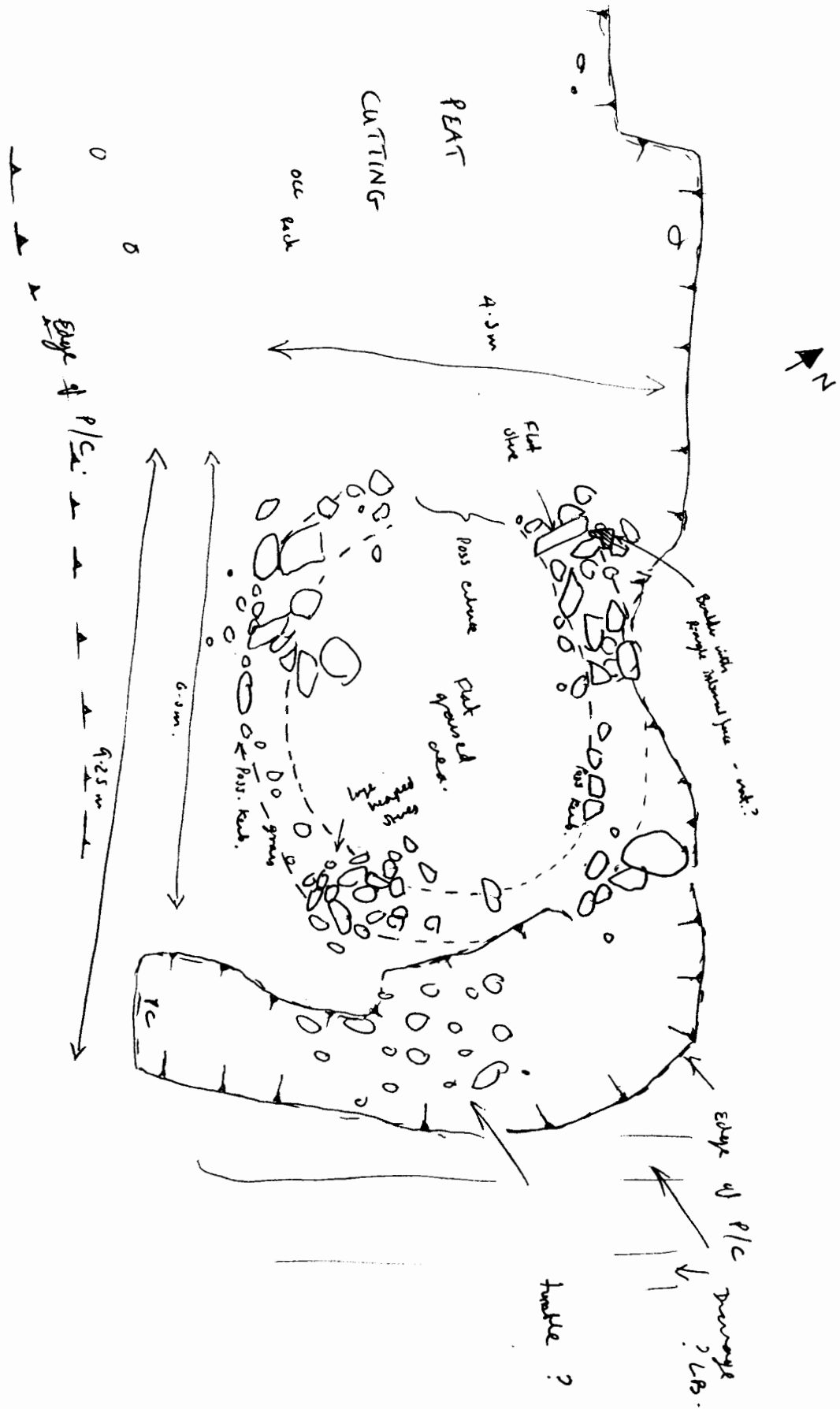

Plan 8: Alltan Dubh, hut circle ? (6/10).

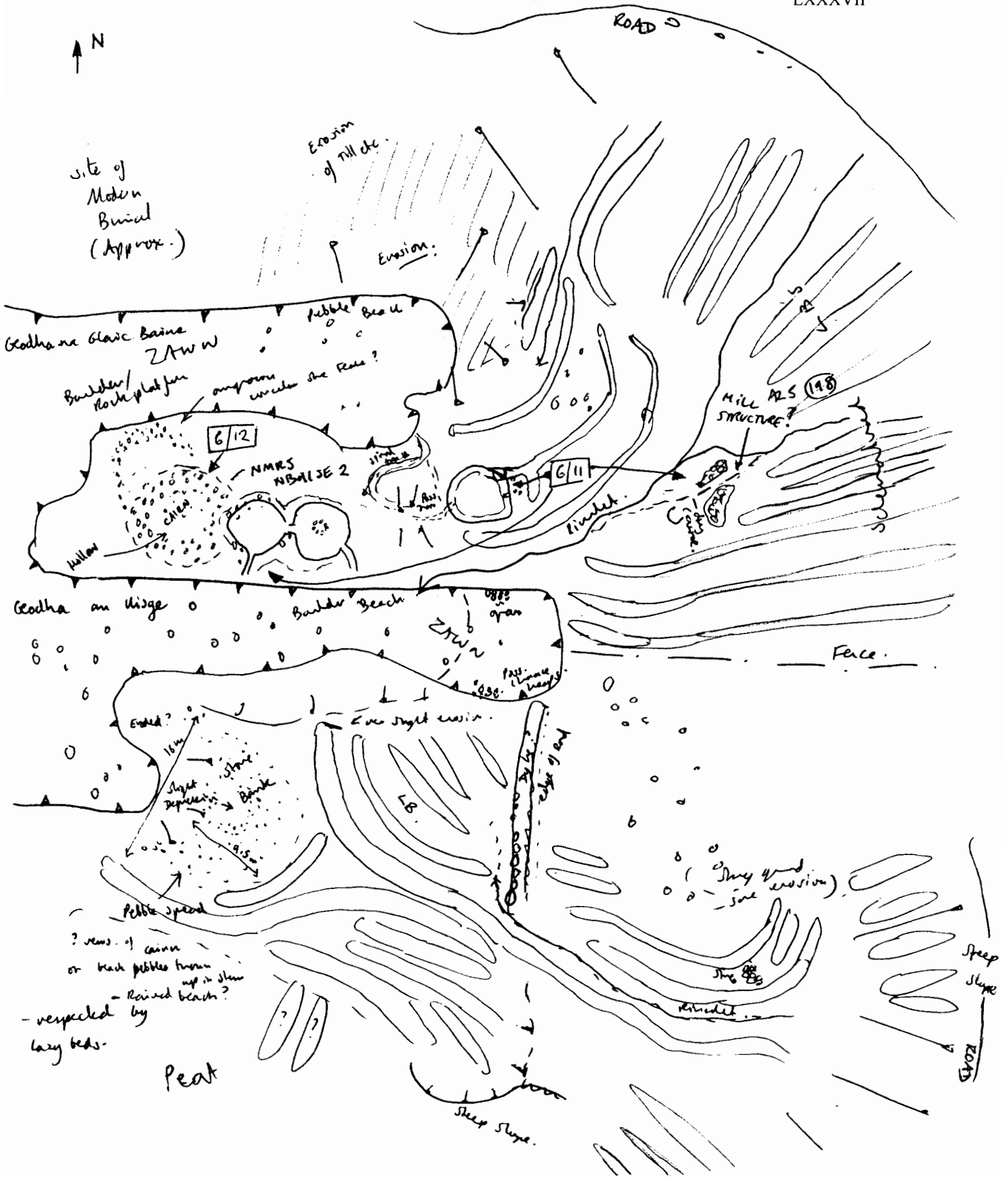

Plan 9: Location plan of Geodha na Glaic Baine site complex, showing lazy bed cultivation, kelp storage pits & mill (6/11), and burial cairn (6/12).

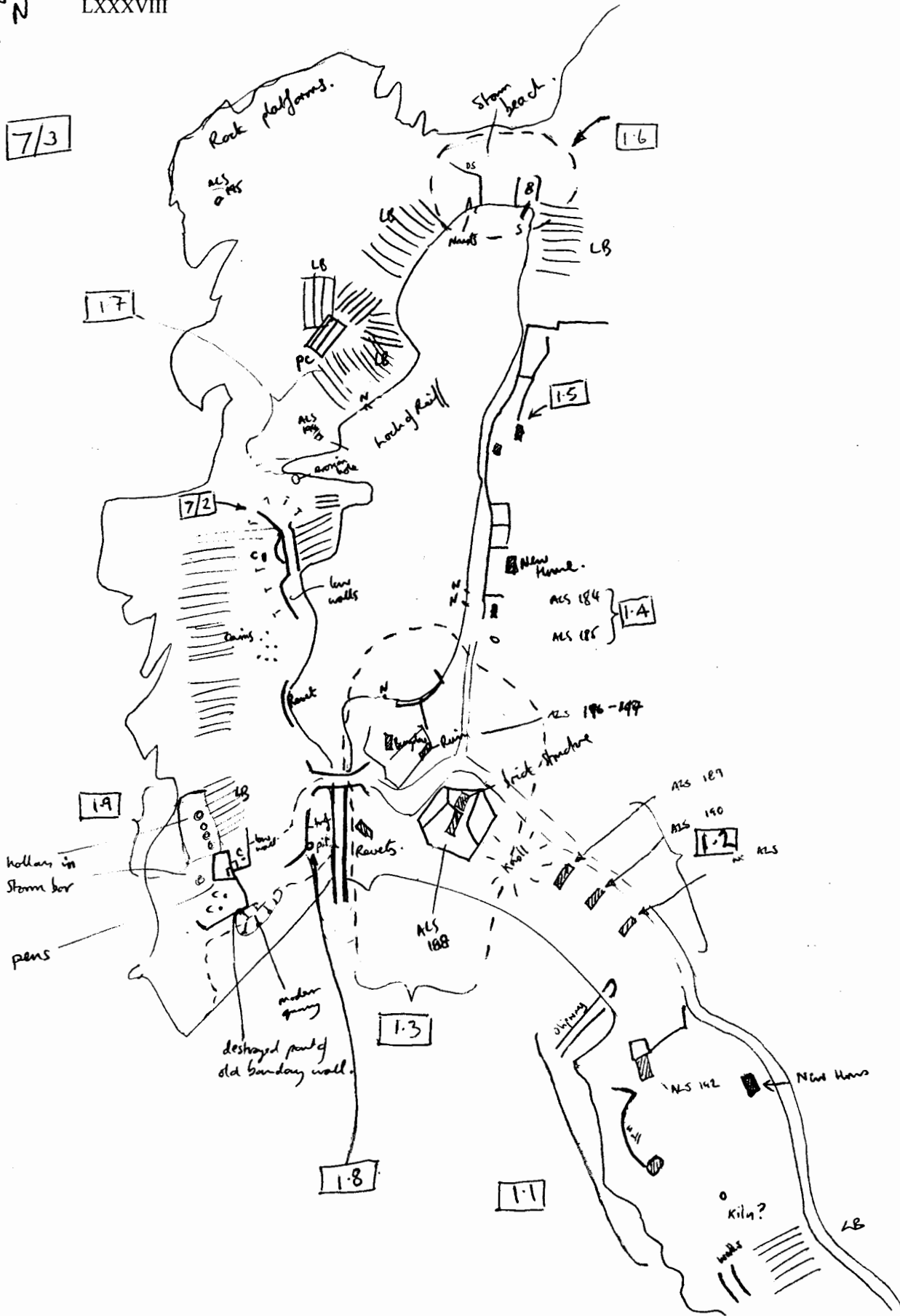

Plan 10: General plan of Reiff Township, showing buildings, structures landscape elements surrounding the Loch of Reiff (7/1.1-9, 7/2 & 7/3).

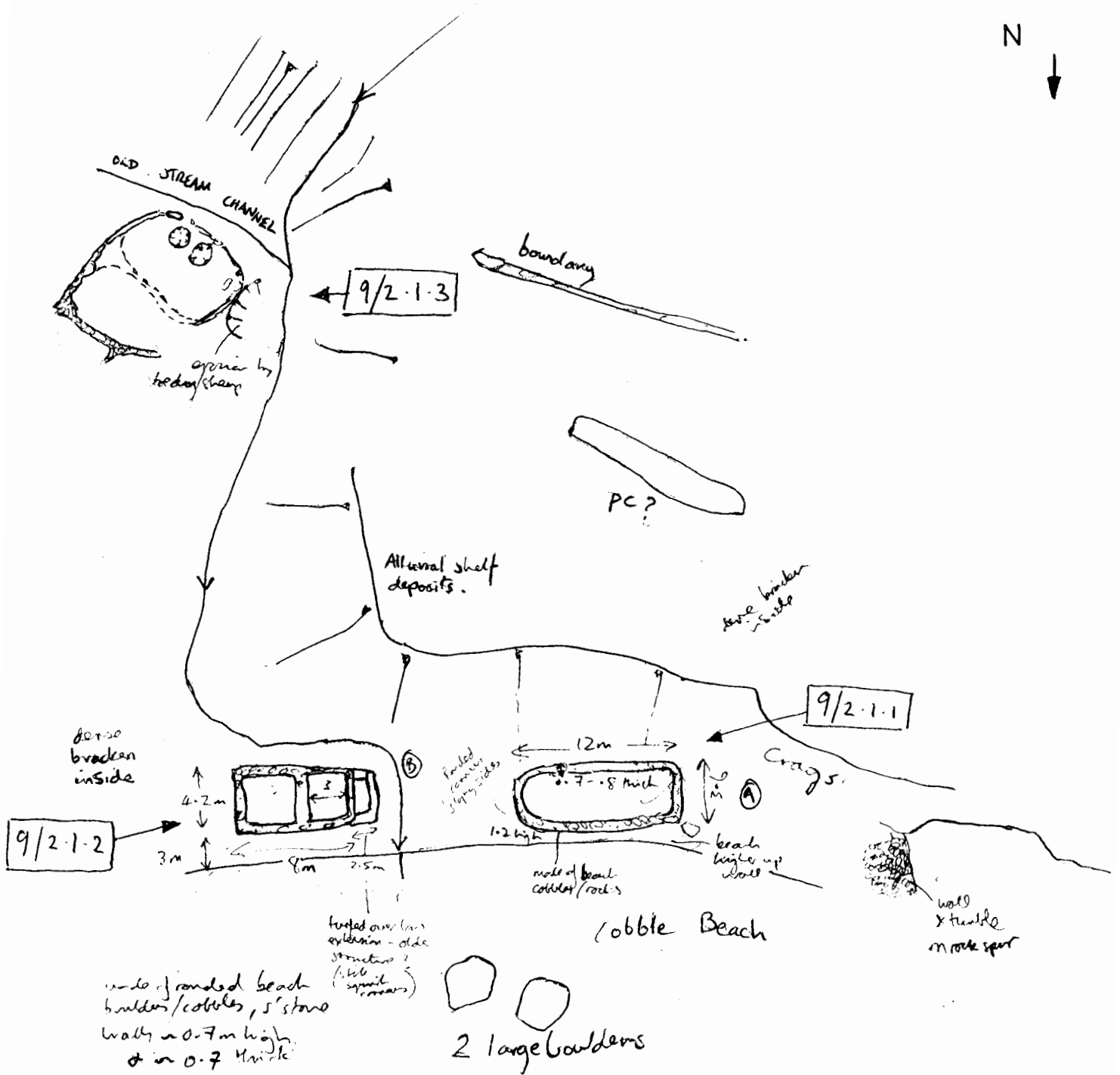

Plan 11: Camas a' Bhothain, showing rectangular buildings (9/2.1.1-2) and subcircular structure (9/2.1.3).

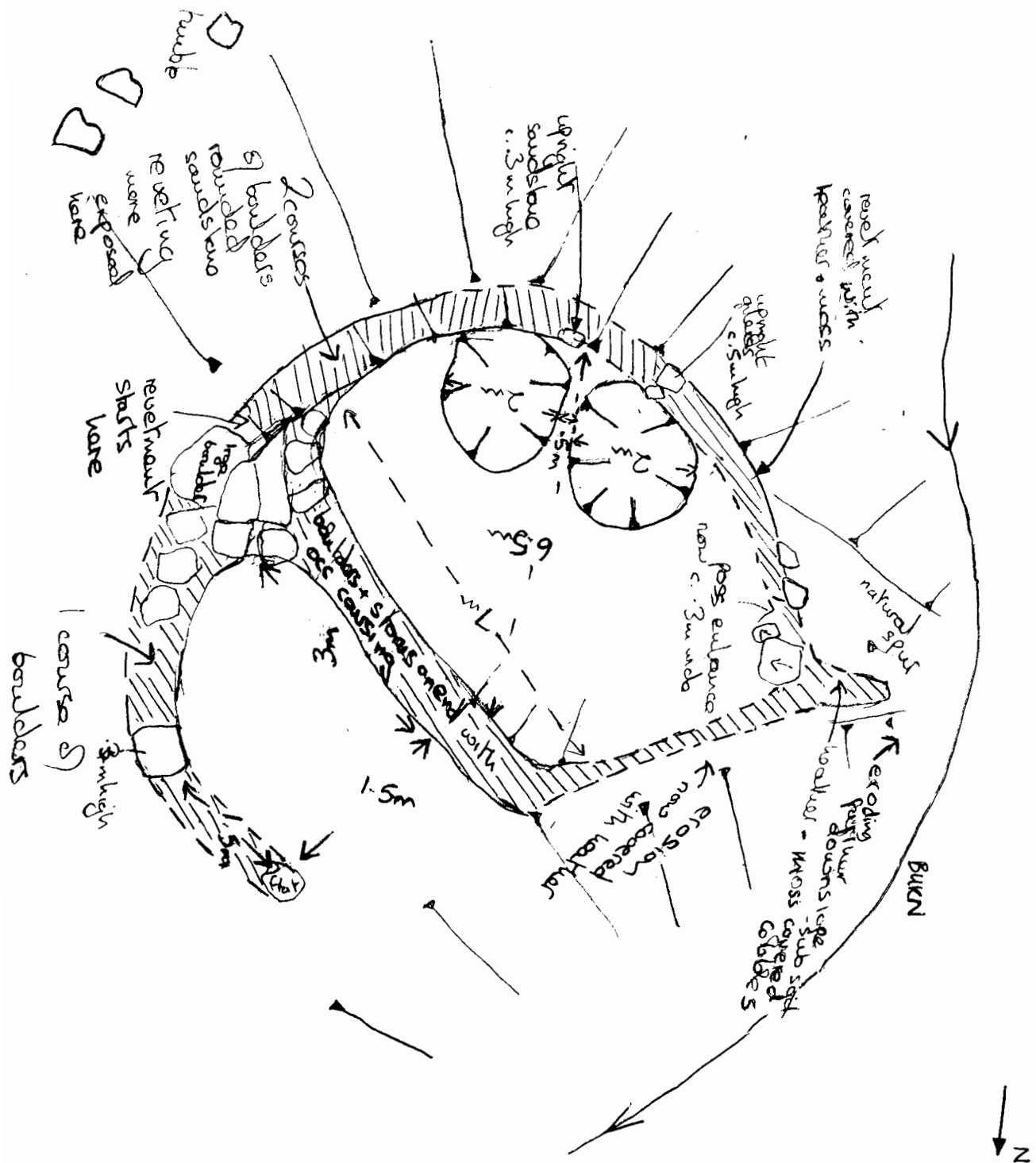

Plan 12: Camas a' Bhothain, plan of subcircular structure (9/2.1.3).

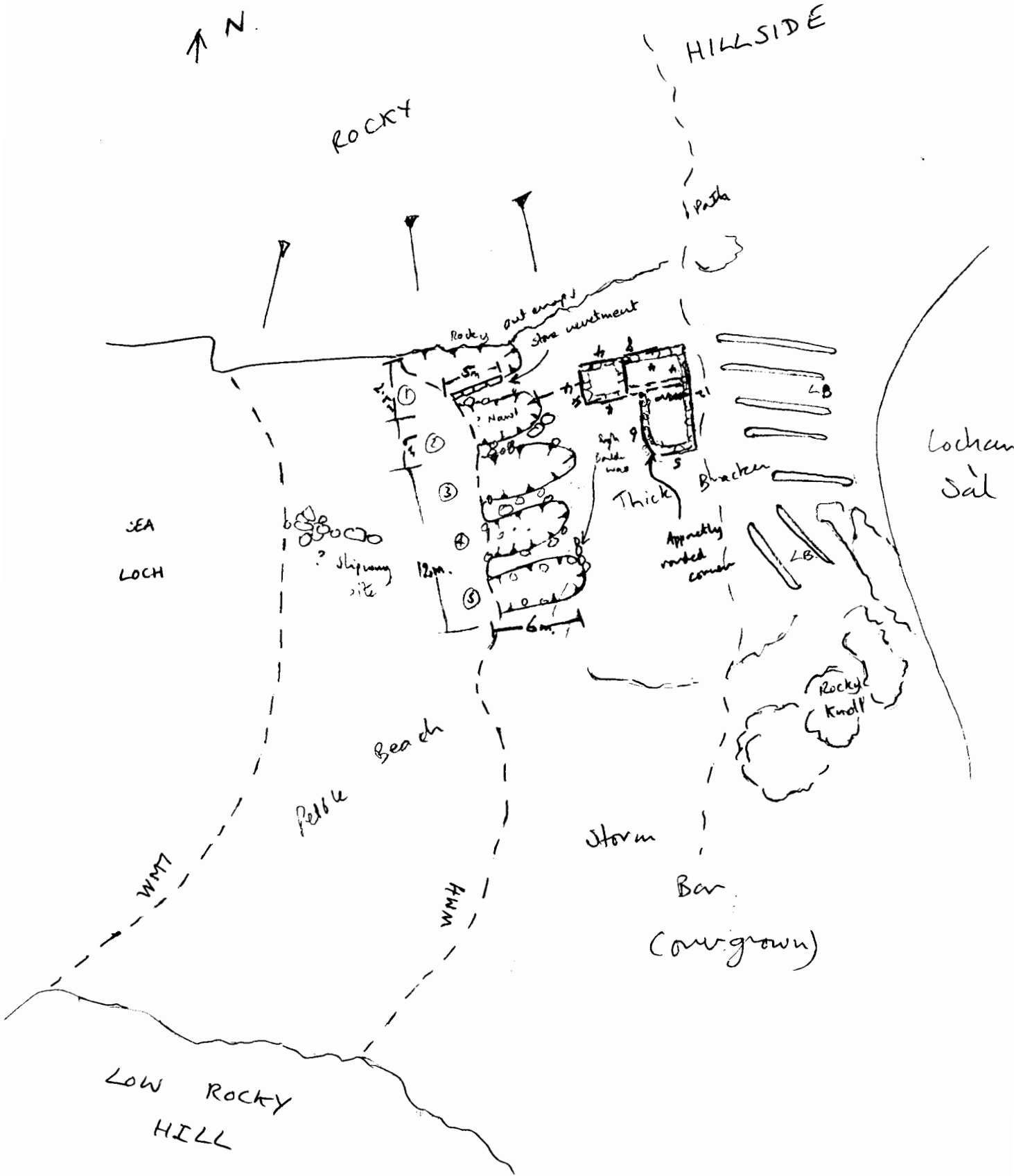

Plan 13: Lochan Säl, plan of site complex (9/8).

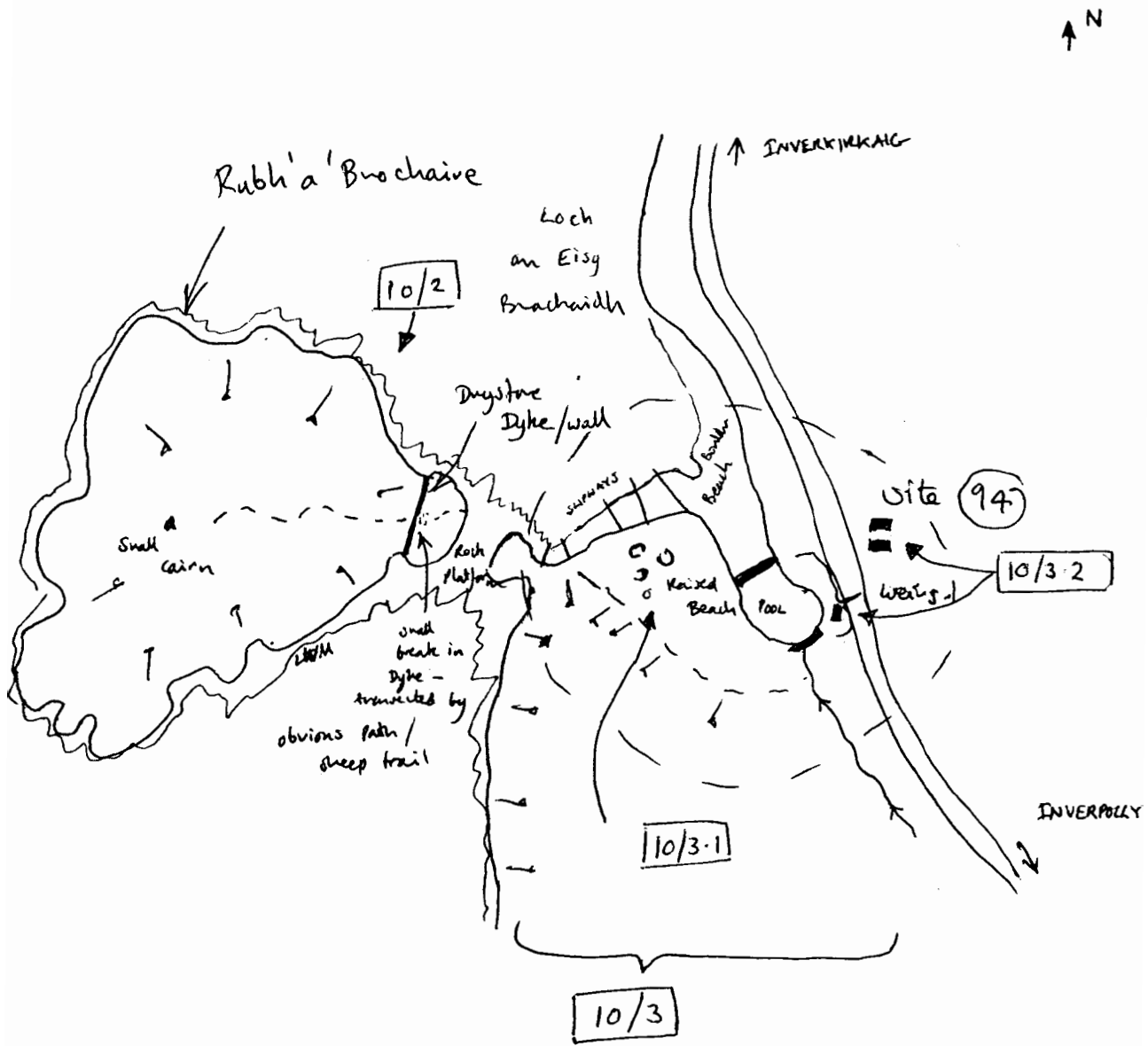

Plan 14: Location plan showing Rubh' a' Brochaire (10/2) and Loch an Eisg Brachaidh (10/3).





LOCH EIS-BRACHAIDH

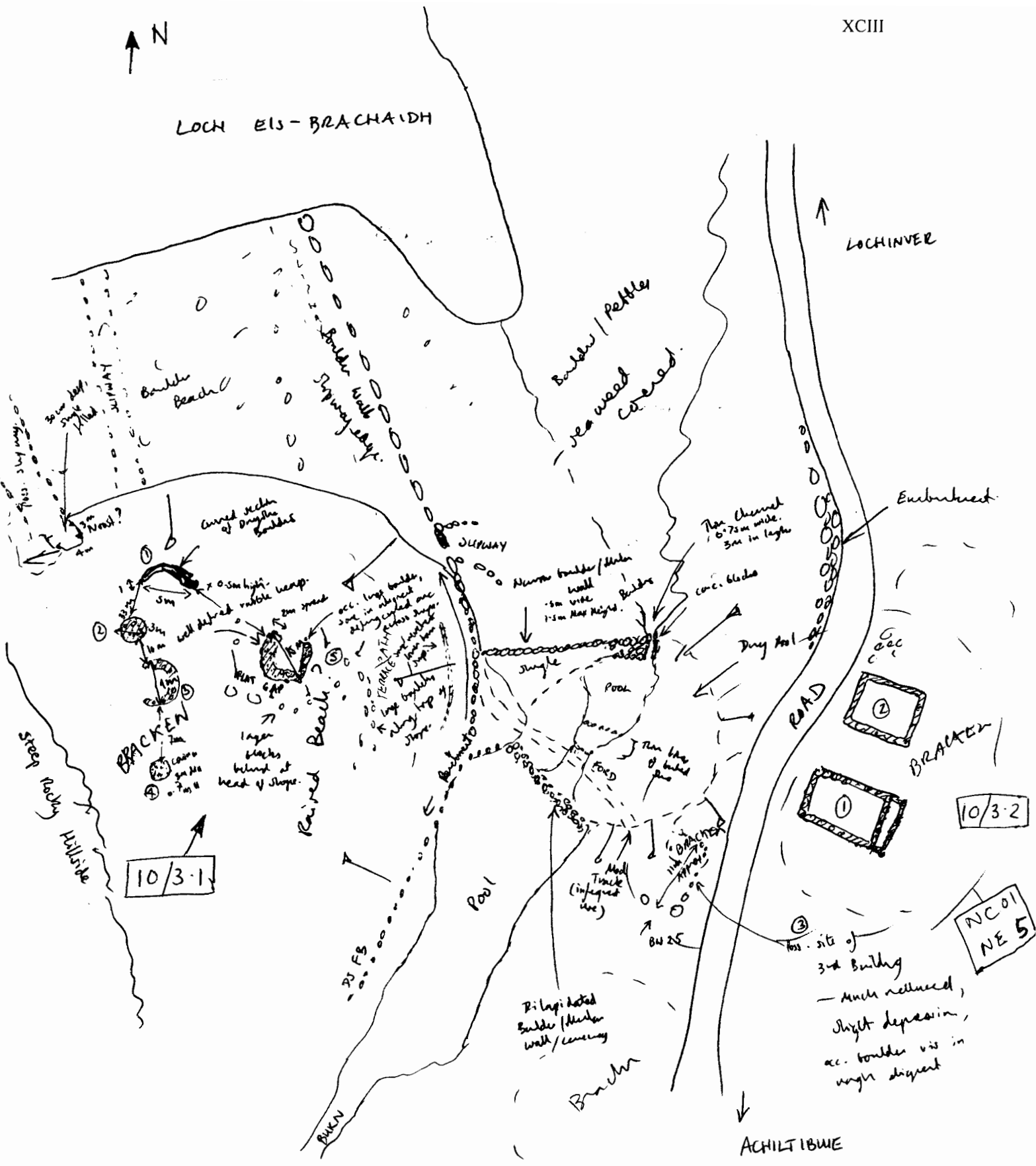

Plan 15: General plan of Loch an Eisg Brachaidh, showing circular structures (10/3.1), rectangular buildings (10/3.2), slipways, weirs and boast nausts..



Section across Road.

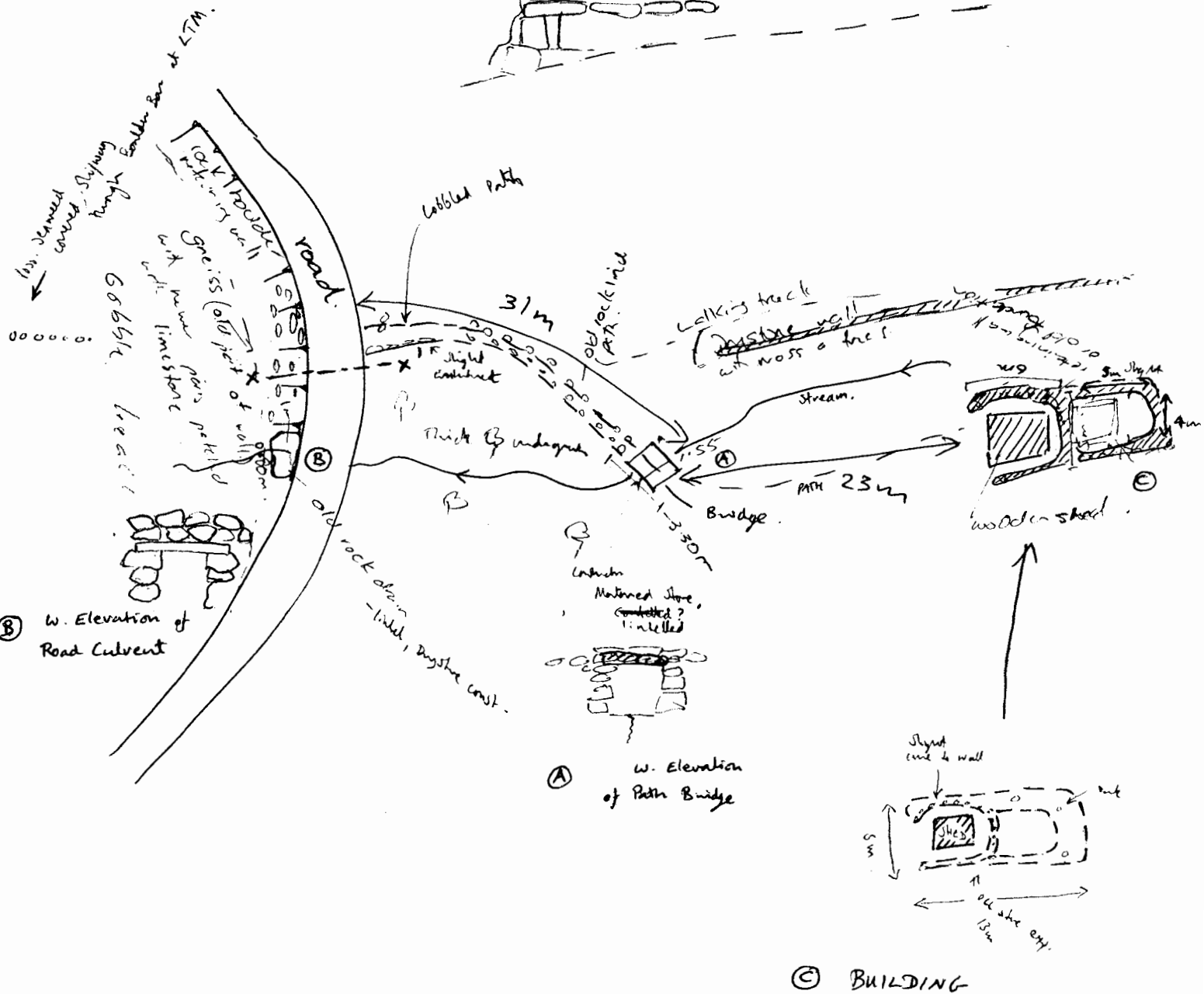
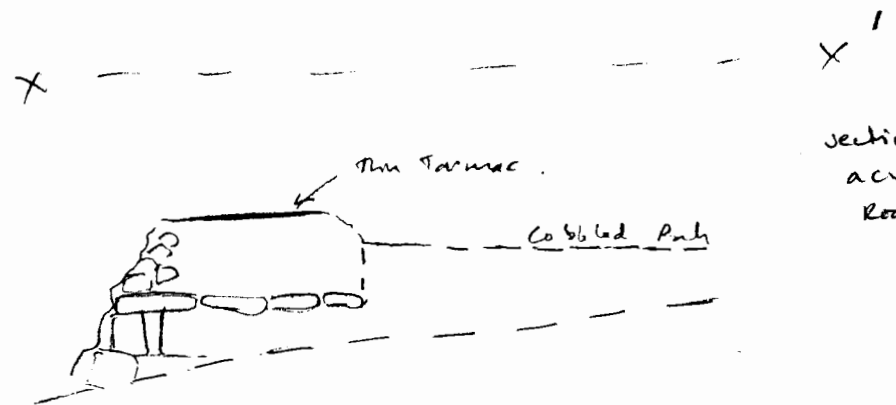

Plan 16: Polly More (10/4), showing building, bridges and drystone walls.

## **COLOUR PLATES**





Plate 12: Camas Beag Fish Trap (NC 2111 9009) exposed at low tide, looking north west along an extremely precipitous stretch of coastline towards the Summer Isles.



Plate 13: Old Dorney Bay (NB 1984 9115). View of the curved west end of structure 1, shell midden and cairn field. Facing SSE.





Plate 14: View of Achnahaird Sands (NC 01 SW 2) from the south east. Note an expanse of salt marsh in the mid distance, and the line of a dyke (part of NC 2018 9127) affected by tidal inundation in the foreground. Zones D, E & F are in the eroding area on the left.

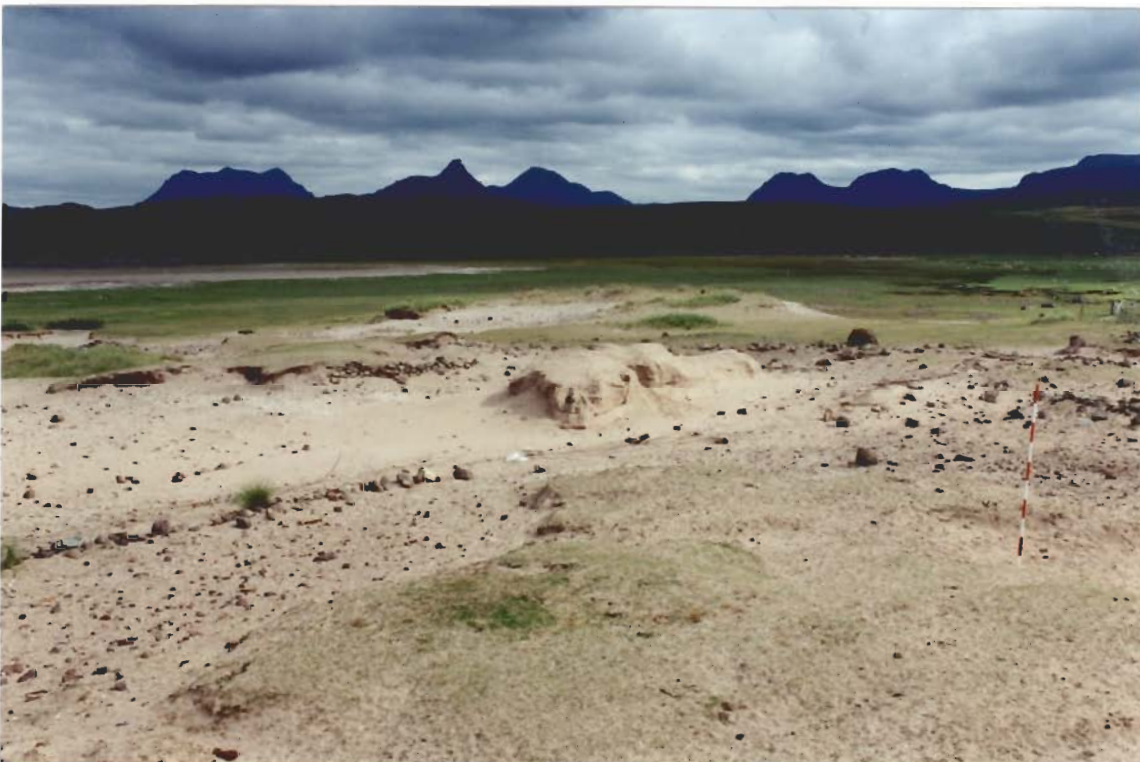

Plate 15: Achnahaird Sands (NC 01 SW 2). General view of Zone D, showing the residual form of an eroding dune mesa which previously protected this area, flanked by buildings 1 (left) and 2 (right). An exposure of shell midden (Zone F) is in the background.



Plate 16: Achnahaird Sands (NC 01 SW 2). Building 2 facing west. Note eroding edge of machair behind the structure. Achnahaird House (NC 01 SW 34) is in the background.



Plate 17: Achnahaird Sands (NC 01 SW 2), Zone E. Eroding section, facing south west, showing *in situ* shell deposit, buried land surface and underlying palaeosol. Note rabbit activity at the base of the section. This land surface has been revealed through the loss of sand dune cover and approximately 1m of machair soil.