

MAP 54: ANNAN TO EASTRIGGS

Hinterland Geology and Coastal Geomorphology: This map depicts the lower tidal reach of the River Eden. The coastal geology is soft and consists of stretches of marine sands, glacial drift and coarse clay deposits. Riverine mud and salt-marsh are a common feature at Gowkesk Rig and further eastwards along the river.

Erosion Class: The foreshore is being eroding by wave attack along the length of this section. However the rate of shoreline recession is not as great as that observed at Powfoot.

Built Heritage & Archaeology: The dominant form of archaeological monuments in this section of the coastline are fishing net stakes and fish traps, distributed in a scattered fashion. Originally many more net stakes existed on the expansive sands revealed at low tide in this area (Solway Salmon Fisheries Commission, 1878-79), the last century witnessing the depletion of fisheries in the area. Although some of the surviving systems may still be used, others are adversely affected by tidal abrasion and monitoring is recommended in regard to these sites. Situated at the coastal edge of this section are two farm buildings and the remains of the Solway Railway Viaduct, a failed business venture of the late nineteenth and early twentieth century (RCAHMS, NY26SW 32).

Map 54: Hinterland Geology and Coastal Geomorphology

1. WATERFOOT to GOWKESK RIG

NY 205 649

2km

Low edge (< 5m)

Marine sands and gravels

The hinterland of this unit consist of marine sands and gravels overlying Carse clays. The foreshore at the HWM is mainly saltmarsh and mud that borders tidal mud-flats.

2. GOWKESK RIG to DORNOCK COTTAGE

NY 214 650

1.5km

Low edge (< 5m)

Marine sands and gravels over carse clay

The hinterland consists of marine sands and gravels overlooking a boulder and mud foreshore. Wide tidal-flats occur out to the main channel of the River Eden.

3. DORNOCK COTTAGE to DORNOCK BROW FARM

NY 224 653

1.5km

Low edge (< 5m)

Glacial sands and gravels

The hinterland is glacial sands and gravels with a parcel of salt-marsh between a break in the topography

4. DORNOCK BROW FARM to south of BAURCH HOLDINGS

NY 260 640

6km

Low edge (< 5m)

Marine sand and gravels

Marine sands and gravels overlie carse clays. The shoreline is bounded by salt-marsh which overlooks the wide tidal mud-flats of the River Eden.

MAP CLASS: Hinterland Geology and Foreshore Geomorphology
 Assessment date: November 1996
 Scale: 1:25 000

ANNAN TO EASTRIGGS
 NGR: NY 20-24/63-67

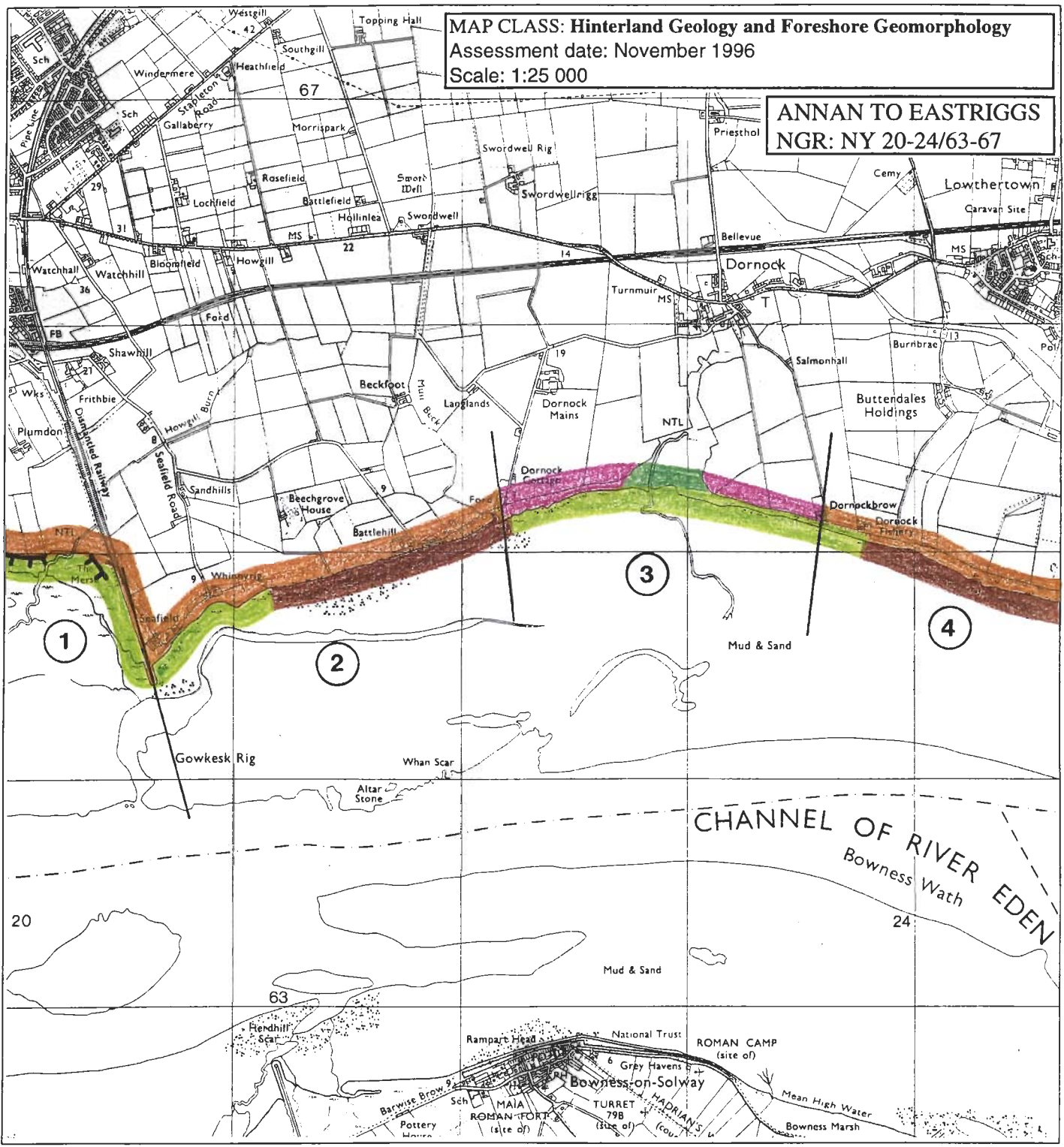

Hinterland Geology	Derwent Code	Colour
Drift, boulder clay	French Grey	[Grey]
Drift, boulder clay over visible rock	Dark Violet	[Violet]
Raised beach and marine deposits	Golden Brown	[Brown]
Blown sand	Pink Madder Lake	[Pink]
Glacial sand and gravel	Magenta	[Magenta]
Alluvium	Emerald Green	[Green]
Coastal Geomorphology		
Mainly rock platform	Deep vermilion	[Red]
Mainly sand	Ultramarine	[Blue]
Mainly alluvial/marine mud	Venetian Red	[Red]
Marsh	May Green	[Yellow-Green]
Coast Edge		
Low edge (<5m)	Thin black line	[Thin line]
Cliff (>5m)	Solid black line	[Solid line]
Man made barrier	Black line with spines	[Line with spines]
Shingle beach	Small circles	[Circles]
Human disturbance	Black carats	[Carats]

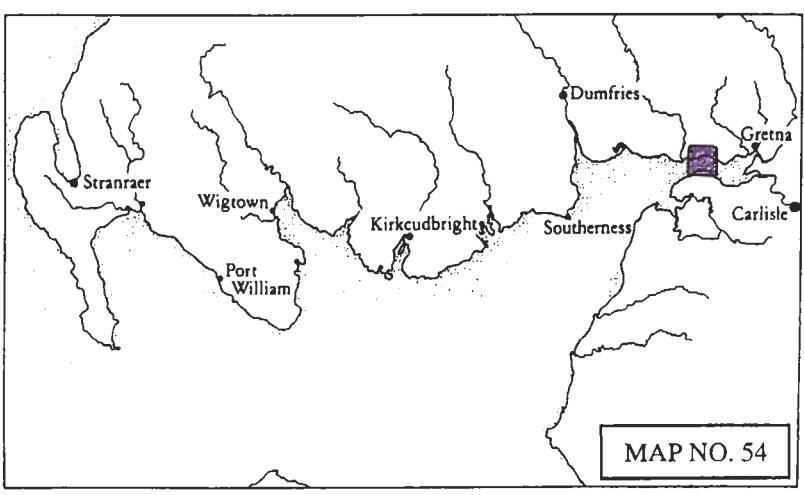

MAP NO. 54

MAP 54: EROSION

1. SEAFIELD to TORDUFF POINT

NY 240 650

6km

Definitely eroding

This unit shows evidence of erosion at the HWM owing to the soft nature of the drift material (clays). The saltmarsh is failing to protect this region of coastline owing to accelerated mass movement caused by the large spring tides.

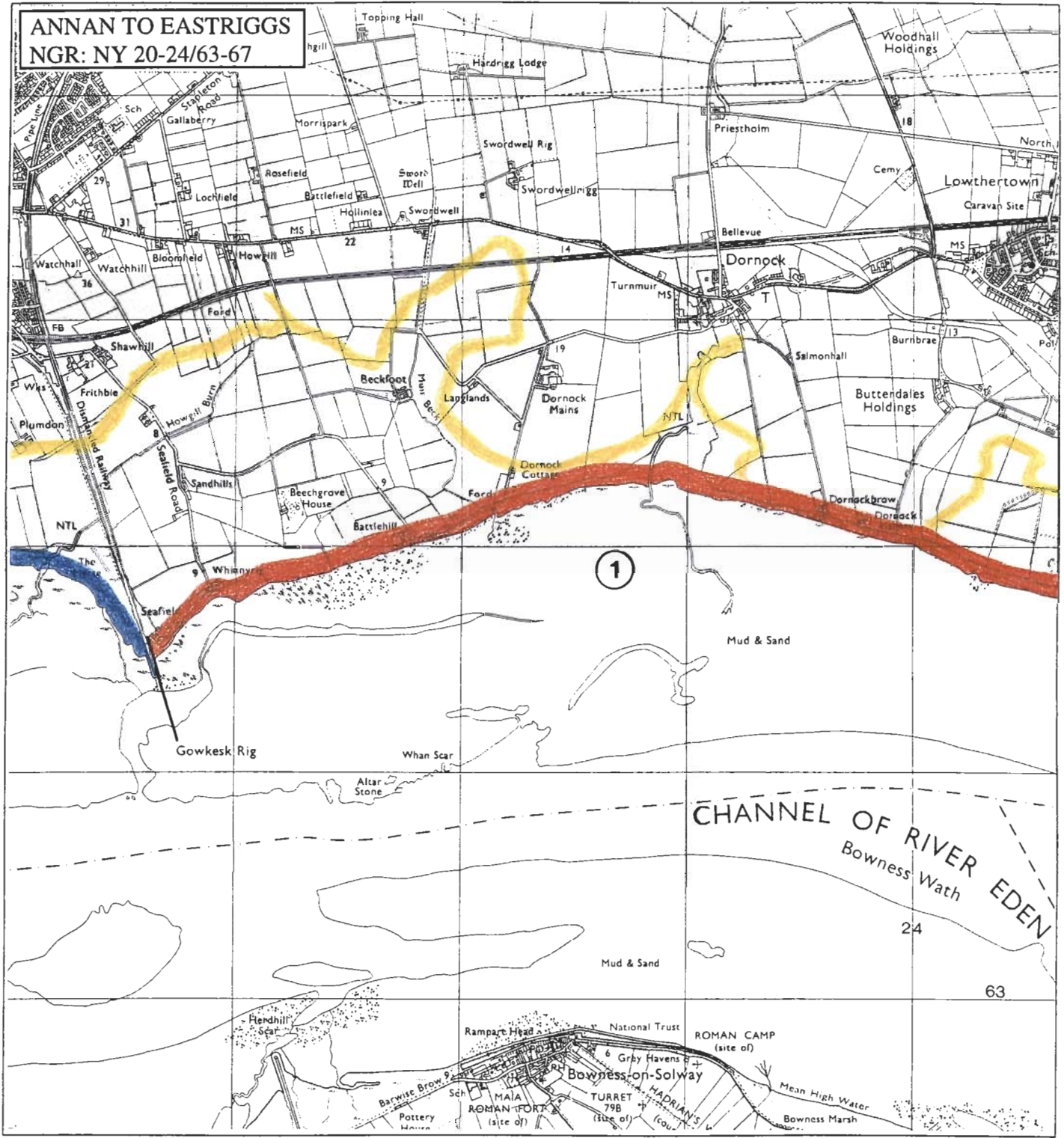

KEY

Erosion class	Derwent Code	Colour
Definitely accreting	Prussian Blue	
Accreting/stable	Light Blue	
Stable	Grass Green	
Stable/eroding	Deep Chrome	
Definitely eroding	Deep Vermilion	
Both accreting and eroding	Imperial Purple	
No access	Blank	
Land below 10m	Straw Yellow	

MAP CLASS: EROSION
Assessment date: 07.10.96
Scale 1:25 000

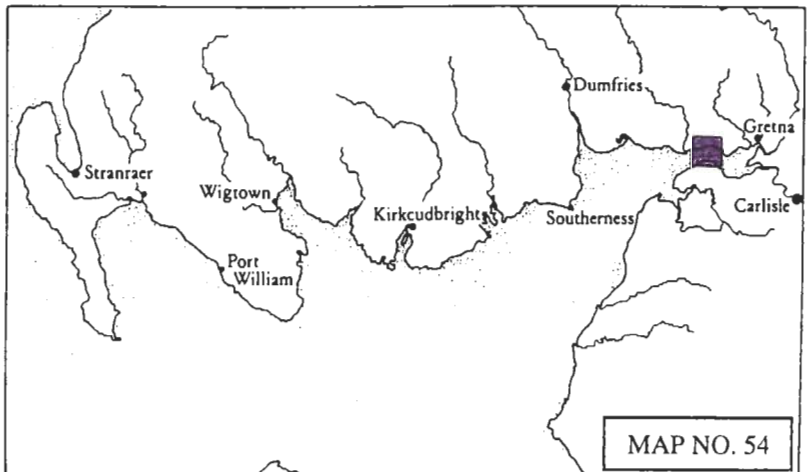

MAP NO. 54

MAP 54: BUILT HERITAGE AND ARCHAEOLOGY

Sites on the Coast Edge & Foreshore

NY 2050 6444
SEAFIELD
Fishtrap
Uncertain
Fair
Monitor

NY26SW 33
NY 2062 6242
SOLWAY VIADUCT
Railway Viaduct
19th century
Good
Nil

NY26SW 32
NY 2087 6481
WHINNYRIGG
Barn
Uncertain
Good
Nil

NY26NW 14
NY 2178 6503
BATTLEHILL
Cottage & Outbuildings
Uncertain
Good
Nil

NY 2190 6506
BATTLEHILL
Fishtrap - Step Plan Trap
Uncertain
Good
Nil

NY 2272 6520
DORNOCK
Fish Traps
Uncertain
Poor
Monitor

Sites in the Hinterland

None

NY 23 65
DORNOCK FISHERY
Fish Trap
Uncertain
Fair
Monitor

NY 2392 6501
DORNOCK FISHERY
Fish Traps
Uncertain
Poor
Monitor

MAP CLASS: Built Heritage and Archaeology

Assessment date: October 1996

Scale: 1:25 000

ANNAN TO EASTRIGGS

NGR: NY 20-24/63-67

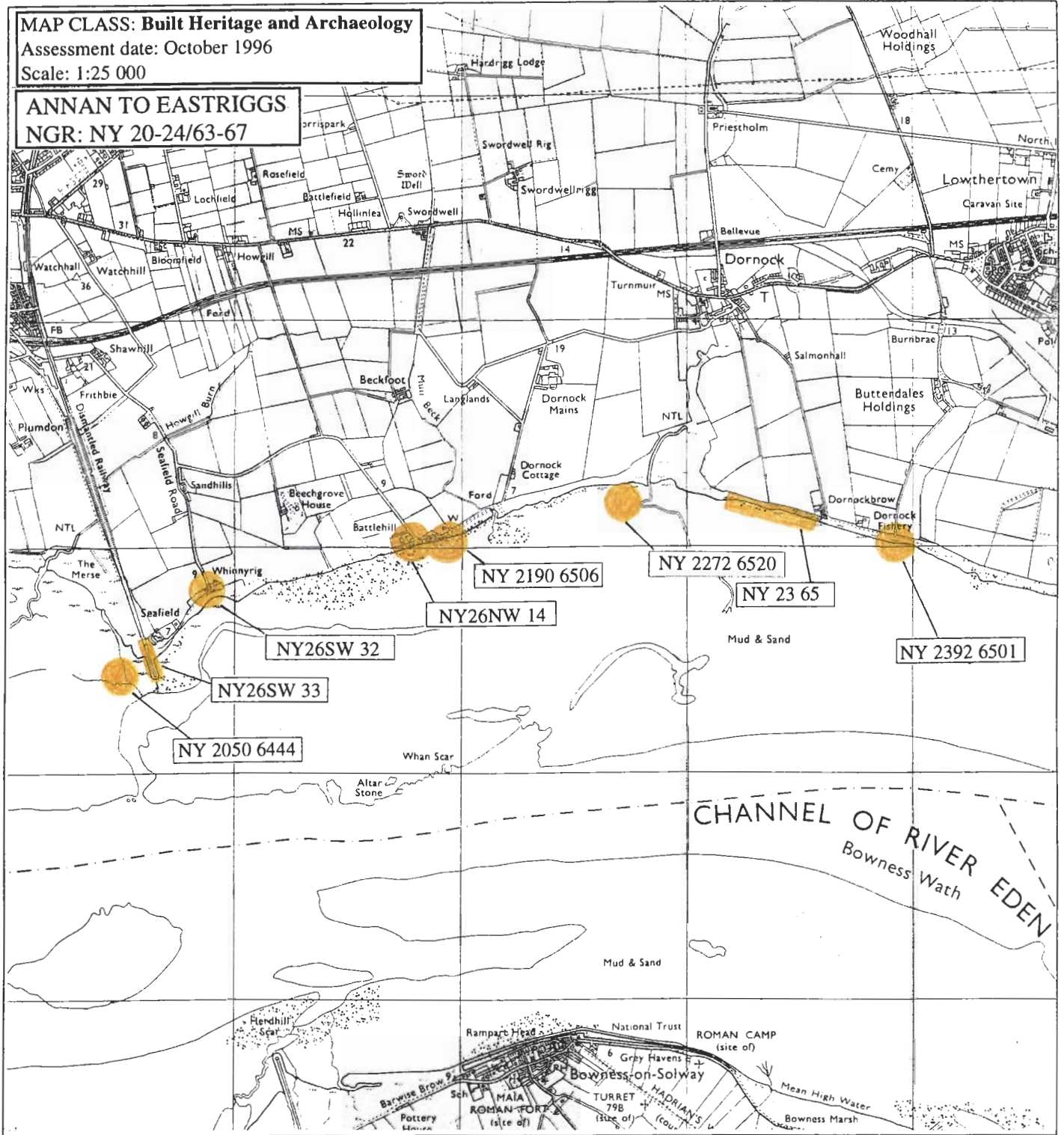

KEY

Site location	Symbol	Colour	Significance
NGR ref. - eg.	Roundel - Solid, (or area)	Red	Protected Ancient Monument
	Cross	Red	Listed Historic Building
NX 143 368	Roundel - Open, (or area)	Red	Monument formally proposed by Historic Scotland for designation
	Roundel - Solid, (or area)	Yellow	Other known Ancient Monument
NMRS ref. - eg.	Dashed outline	Yellow	Gardens/Designed landscape
NX 13 SW 17	Roundel - Solid, (or area)	Yellow	Undesignated wreck
	Area	Green	Insufficient information; more work needed
	Area	Blue	Probably archaeologically sterile

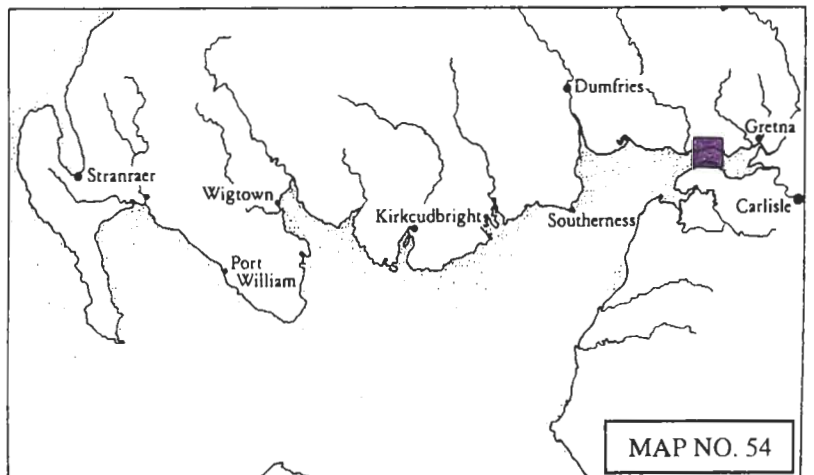

MAP NO. 54

