

MAP 6: WEST FREUGH TO WHITECROOK

Hinterland Geology and Coastal Geomorphology: This region of the coast is a continuation of the long sand dune system of Torrs Warren shown on the previous map. The dune system ends at Ringdoo Sands where the Piltanton Burn flows into Luce Bay. The edge of the burn is dominated by salt and brackish marsh vegetation. The intertidal area in front of the dunes consists of a wide sandy beach known as Luce Sands.

Erosion Class: No erosion was recorded on this stretch of the dunes and conditions are considered to be stable. From Ringdoo Sands to Whitecrock (Unit 2), (via Piltanton Bridge) the banks along burn are eroding only slowly due to the density of marsh vegetation.

Built Heritage & Archaeology: The archaeology of this section includes a range of prehistoric, early historic and medieval sites and findspots located in the extensive sand dune system of Torrs Warren. At the moment the dune system is under thick vegetation and is thus extremely stable, with only a few isolated spots of exposed sand, due to rabbit action, open to wind erosion. Many of the sites represent chance findspots, poorly provenanced (Williams, 1977, 77) and are only located to a four figure grid reference.

Map 6: Hinterland Geology and Coastal Geomorphology

1. LUCE SANDS M.O.D. FIRING RANGE

NX 142 542

9km

Low edge (< 5m)

Sand dunes

The head of Luce Bay is a well formed 'hindshore' dune system with crescent shaped sand ridges. The foreshore is a sand with shingle in parts.

2. RINGDOO SANDS to south of WHITE

CROOK FARM

NX 142 542

1km

Low edge (< 5m)

Saltmarsh backed by sand dunes

Sheltered mouth of the Pitanton Burn. Alluvium underlies saltmarsh with a planted frontal sand dune system in the hinterland.

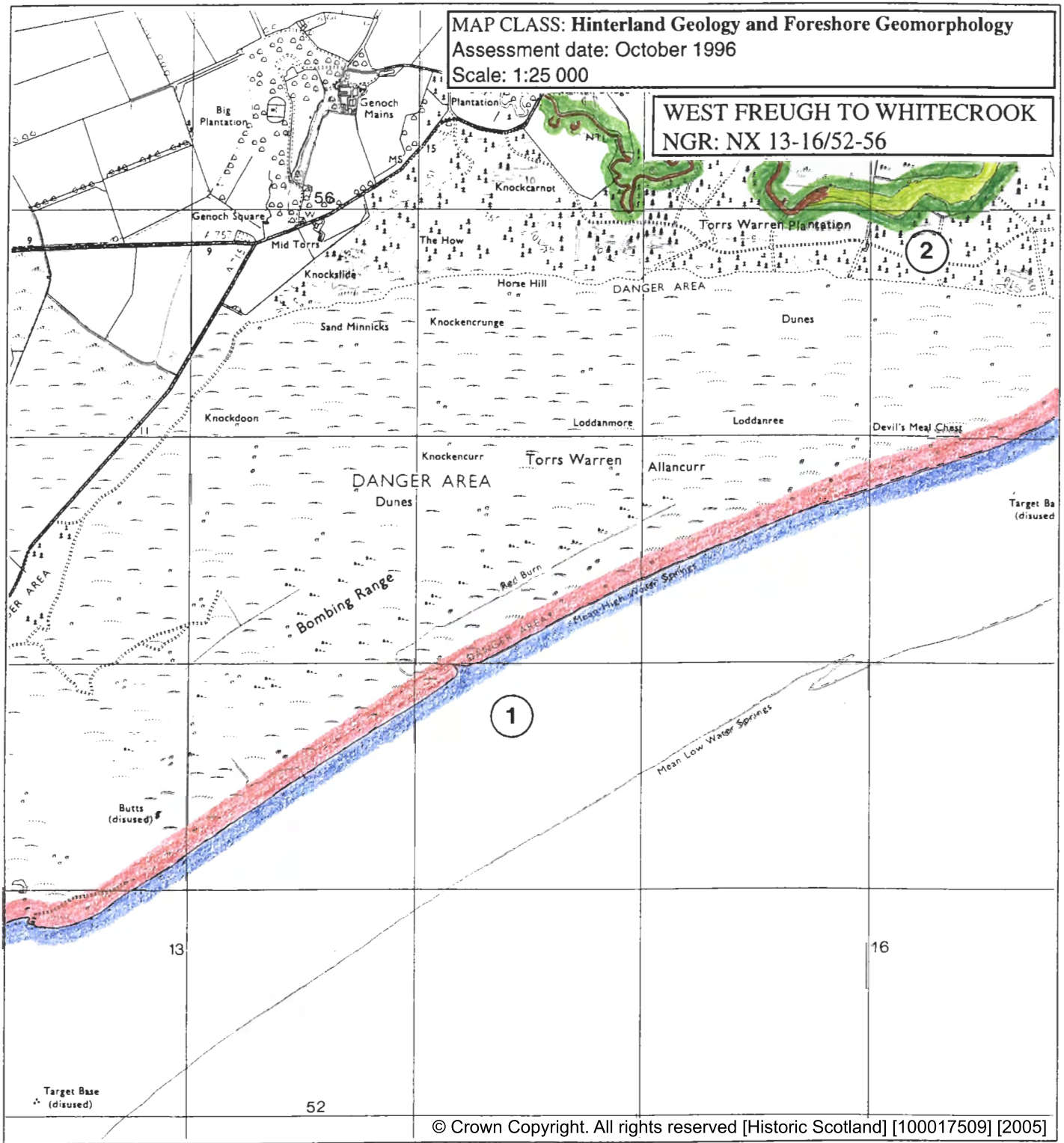

KEY

Hinterland Geology	Derwent Code	Colour
Drift, boulder clay	French Grey	
Drift, boulder clay over visible rock	Dark Violet	
Raised beach and marine deposits	Golden Brown	
Blown sand	Pink Madder Lake	
Glacial sand and gravel	Magenta	
Alluvium	Emerald Green	
Coastal Geomorphology		
Mainly rock platform	Deep vermilion	
Mainly sand	Ultramarine	
Mainly alluvial/marine mud	Venetian Red	
Marsh	May Green	
Coast Edge		
Low edge (<5m)	Thin black line	
Cliff (>5m)	Solid black line	
Man made barrier	Black line with spines	
Shingle beach	Small circles	OOOOOO
Human disturbance	Black carats	AAAAAA

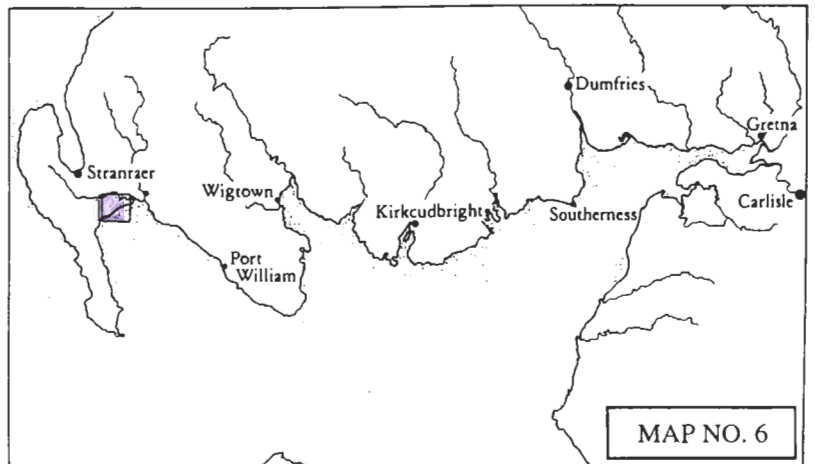

MAP 6: EROSION

4. CLAYSHANT to RINGDOO SANDS

NX 140 540

7.5km

Stable

This unit forms the head of Luce Sands and is a fairly uniform stretch of coastline comprising stable sand dunes stabilised by dense bracken and heather. The wide intertidal zone is sandy and boulder free.

2. RINGDOO SANDS to PILTANTON

BRIDGE

NX 160 560

4km

Eroding or stable (estimate only)

The lower tidal stretch and upper reach of the Piltanton Burn could not be surveyed due to the dangerous and boggy nature of the marsh.

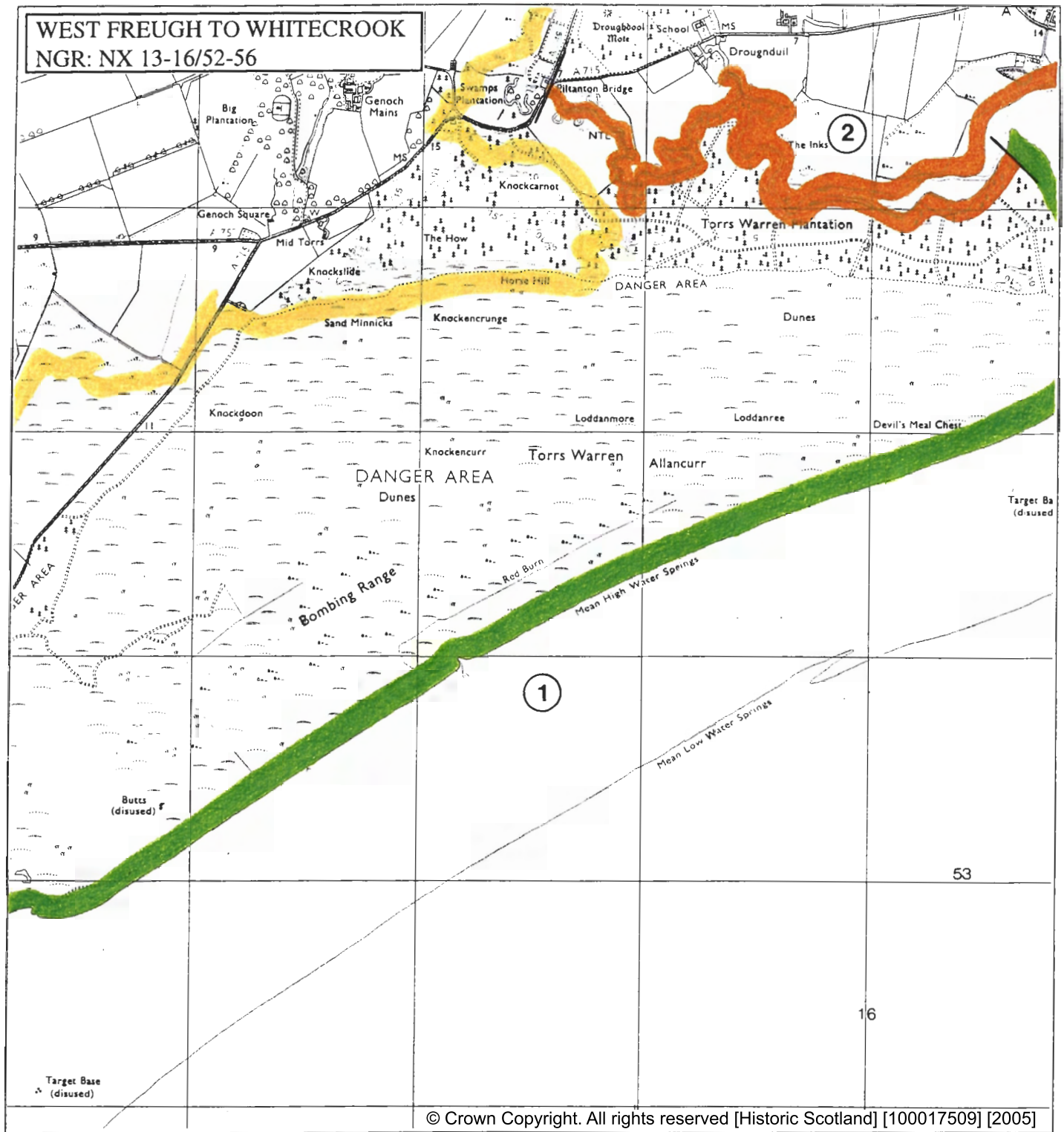

KEY

Erosion class	Derwent Code	Colour
Definitely accreting	Prussian Blue	
Accreting/stable	Light Blue	
Stable	Grass Green	
Stable/eroding	Deep Chrome	
Definitely eroding	Deep Vermilion	
Both accreting and eroding	Imperial Purple	
No access	Blank	
Land below 10m	Straw Yellow	

MAP CLASS: EROSION
 Assessment date: 17.9.96
 Scale 1:25 000

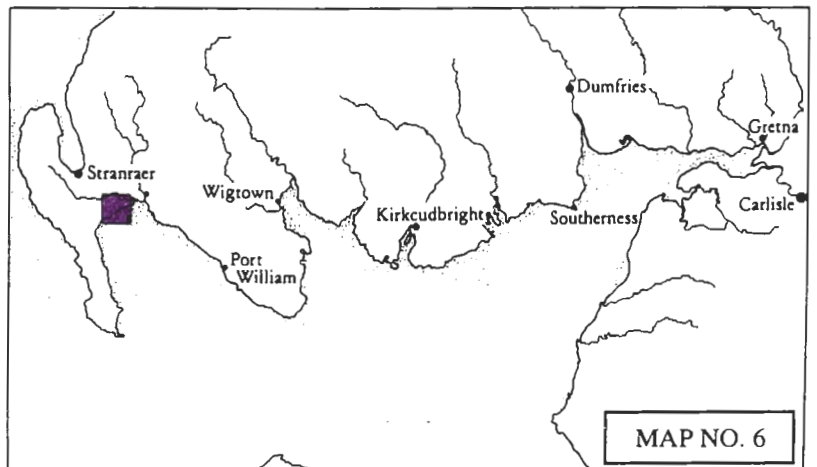

MAP 6: BUILT HERITAGE AND ARCHAEOLOGY

Sites on the Coast & Foreshore

None

Sites in the Hinterland

NX15SW 3

NX 1 5
LUCE SANDS
Bronze axe, pottery,
flints &
miscellaneous finds
spots
3rd Mill. BC
onwards
Uncertain; not
located
Nil

NX15SW 13

NX 1 5
LUCE SANDS
Roman Key Findspot
2nd century AD
Uncertain; not
located
Nil

NX15SW 16

NX 1 5
LUCE SANDS
Roman Coin Findspot
4th century AD
Uncertain; not located
Nil

NX15SW 24

NX 1 5
LUCE SANDS
Pottery & Flints
2nd Mill. BC
Uncertain; not located
Nil

NX15SW 25

NX 1 5
LUCE SANDS
Bronze Brooch
Uncertain
Uncertain; not located
Nil

NX15SW 26

NX 1 5
LUCE SANDS
Bronze Pin
5 & 6th centuries AD
Uncertain; not located
Nil

NX 1 5

LUCE SANDS
Mortuary Structure
Uncertain
Uncertain; not located
Nil

MAP CLASS: Built Heritage and Archaeology

Assessment date: September 1996

Scale: 1:25 000

WEST FREUGH TO WHITECROOK

NGR: NX 13-16/52-56

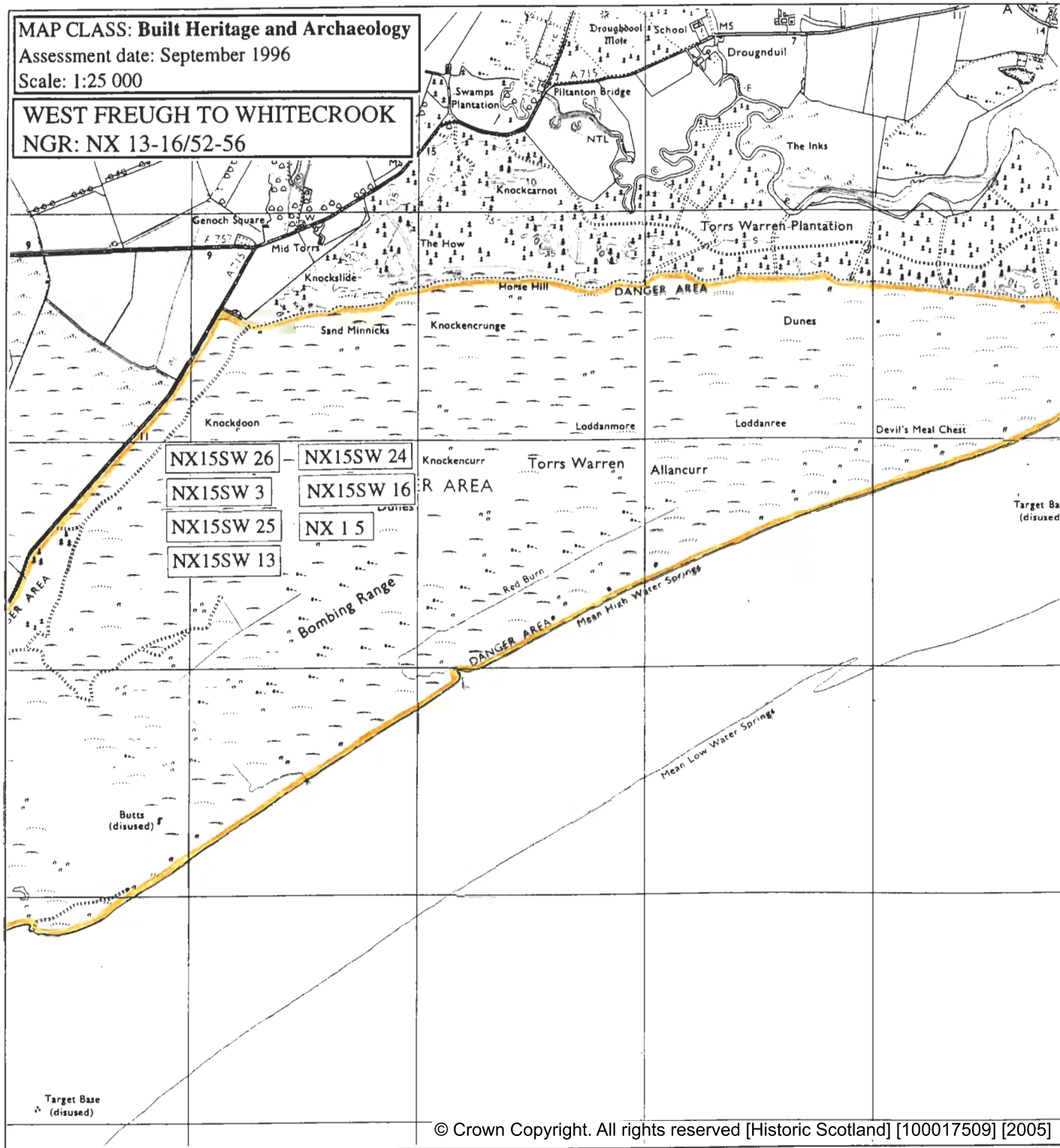

© Crown Copyright. All rights reserved [Historic Scotland] [100017509] [2005]

KEY

Site location	Symbol	Colour	Significance
NGR ref. - eg.	Roundel - Solid, (or area)	Red	Protected Ancient Monument
	Cross	Red	Listed Historic Building
NX 143 368	Roundel - Open, (or area)	Red	Monument formally proposed by Historic Scotland for designation
NMRS ref. - eg.	Roundel - Solid, (or area)	Yellow	Other known Ancient Monument
	Dashed outline	Yellow	Gardens/Designed landscape
NX13 SW17	Roundel - Solid, (or area)	Yellow	Undesignated wreck
	Area	Green	Insufficient information; more work needed
	Area	Blue	Probably archaeologically sterile

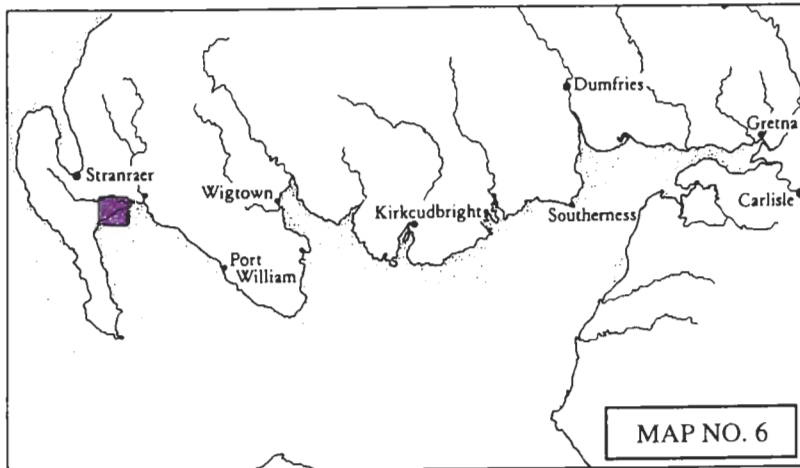

MAP NO. 6

